

STATISTICS		
PROPOSED LAND USE	LOT/BLOCK AREA	
SINGLE DETACHED RESIDENTIAL	1-51	3.56ha
PROPOSED ROADS (644 LIN.M.)		1.19ha
OPEN SPACE & RESERVES	53, 55-62	2.00ha
STORMWATER MANAGEMENT	52	0.57ha
PUMPING STATION	54	0.11ha
TOTAL AREA		7.43ha

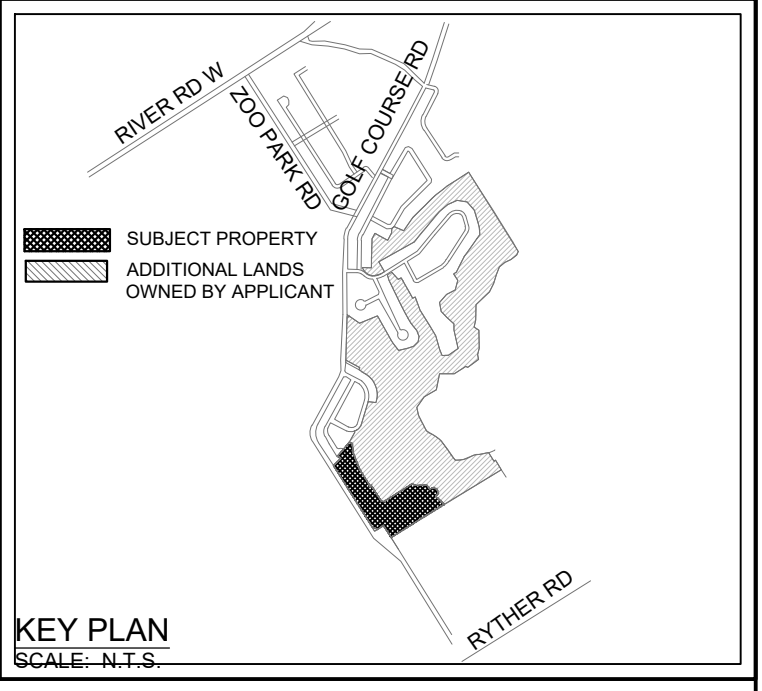

**ADDITIONAL INFORMATION**  
 As required under Section 51(17) of the Planning Act.  
 a), b), e), f), g) & j) - on plan  
 c) - on key plan  
 d) - see statistics  
 h) - piped water to be installed by developer  
 i) - sandy  
 k) - all municipal services to be made available  
 l) - nil

APPROVED SUBJECT TO CONDITIONS IN ACCORDANCE WITH SECTION 51(31) OF THE PLANNING ACT, RSO, CAP. P.13, AS AMENDED.  
 THIS \_\_\_\_\_ DAY OF \_\_\_\_\_  
 DIRECTOR OF PLANNING, DEVELOPMENT AND TOURISM,  
 COUNTY OF SIMCOE

**OWNER'S CERTIFICATE**  
 I authorize LOFT Planning Inc. to prepare and submit this Plan of Subdivision for approval.

**SURVEYOR'S CERTIFICATE**  
 I hereby certify that the boundaries of the lands being subdivided and their relationship to the adjacent lands are accurately and correctly shown.

**LEGEND**  
 ■■■ PROPERTY LINE  
 --- LOT LINE

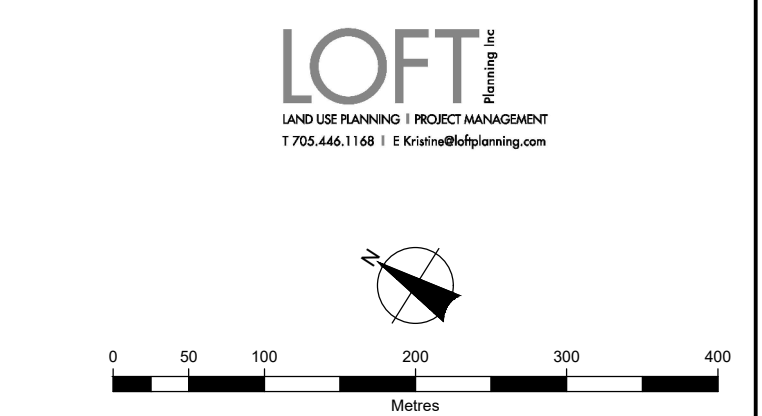

**BURNSIDE**  
 Client: **TPC MARLWOOD INC.**  
 Figure Title: **MARLWOOD MASTER'S LANE EXTENSION**  
 PRELIMINARY DRAFT PLAN  
 Drawn: EDT, Checked: JO, Date: 20/01/14, Figure No.: 1  
 Scale: 1:750, Project No.: 300037815

